



METABOLIC MEDICINE
OF MISSISSIPPI
DIABETES AND ENDOCRINE SPECIALISTS

1551 E. County Line Road • Jackson, Mississippi 39211 • Phone: (601) 790-1233 • Fax: (601) 397-6492

Dr. Honey E. East FACP

Christy Davis, DNP, FNP-C, CDE

JoAnna M. Warren, CFNP, BC-ADM, CDE

Date: _____

Please completely fill out the following.

Name: _____ DOB: _____ SSN: _____

Address: _____ City/ST: _____ Zip Code _____

Cell: _____ Home: _____ Work: _____

Email: _____ Best time to contact: _____

Primary Insurance: _____ Policy #: _____ Group #: _____

Secondary Insurance: _____ Policy #: _____ Group #: _____

Emergency Contact: _____ Phone: _____ Relation: _____

Primary Care Provider: _____

Preferred Pharmacy: _____ Pharmacy location: _____

List of current medications:

List any allergies:

List of surgeries/hospitalizations:

List any past family medical history:

REVIEW OF SYSTEMS: Please CIRCLE ALL that apply to you. Failure to answer may affect your medical care.

Name: _____ Sex: _____ DOB: _____ Date: _____

GENERAL:

Weight: Stable Gain/Loss _____ pounds over _____ months

Energy levels:

Low Stable Increased

EYES:

Seeing Double Red eyes
Change in vision
Change in ability to see out of side of eyes (peripheral vision)

EARS/NOSE/MOUTH/THROAT:

Nosebleeds Runny nose Sore throat
New spacing of teeth
Dry mouth Mouth Ulcers Change in voice

NECK:

Change in appearance
Soreness on front of neck
Trouble swallowing
Sensation something stuck in throat

HEART:

Chest pain Heart racing

LUNGS:

Trouble breathing at rest Trouble breathing with activity
Trouble breathing when trying to sleep
Wheezing Cough Snoring
Sleep apnea- Wearing CPAP? Yes No
Recent Sleep study? Yes No

GASTROINTESTINAL:

Nausea Vomiting Constipation Diarrhea
Abdominal pain Pancreas problems

MUSCULOSKELETAL:

Joint pain Muscle pain Weakness
Change in shoe size Change in ring size
Broken bone or fracture Bone Density test

NEUROLOGICAL:

Tremors Seizures Headaches

ENDOCRINE:

Heat intolerance/hot flashes
Cold intolerance/chills increased thirst
Breast enlargement Breast leakage
History of kidney stones UTIs
Frequent urination Yeast infections

SKIN:

Rashes New stretch marks Do you bruise easily?

PSYCHIATRIC:

Trouble with memory Trouble with concentration
Mood Swings Sadness Anxiety
Falling asleep at inappropriate times

MEDICATIONS:

Recent injections (Decadron, joint, spine, etc...) Steroid
creams, inhaler, nose spray
Over the counter cold medication
Over the counter vitamin supplements

For FEMALES ONLY:

Age of first menstruation (cycle): ____
Last Cycle: ____ Irregular cycle: Yes NO
Difficulty getting pregnant: Yes No
Increased hair growth on face/chest: Yes No
Miscarriage: Yes No
Children weighting over 8lbs at birth? Yes No
History of PCOS? Yes No

For MALES ONLY:

Age of puberty: ____
Change in hair growth/frequency in need to shave: Yes
NO
Increase/Decrease in sexual desire: Yes No
Erectile dysfunction: Yes No
Changes in testicles (growth or shrinkage): Yes No
History of testicular infection: Yes No
Biological Children? Yes No

metabolic medicine of mississippi

Metabolic Medicine

Address: 1551 E County Line Rd, Jackson, MS 39211
 Phone: (601) 790-1233



- Nearby**
- Gas Stations
 - Restaurants
 - Malls
 - Search nearby
 - Coffee Shops
 - Grocery Stores
 - Department Stores

Metabolic at Amazon.com

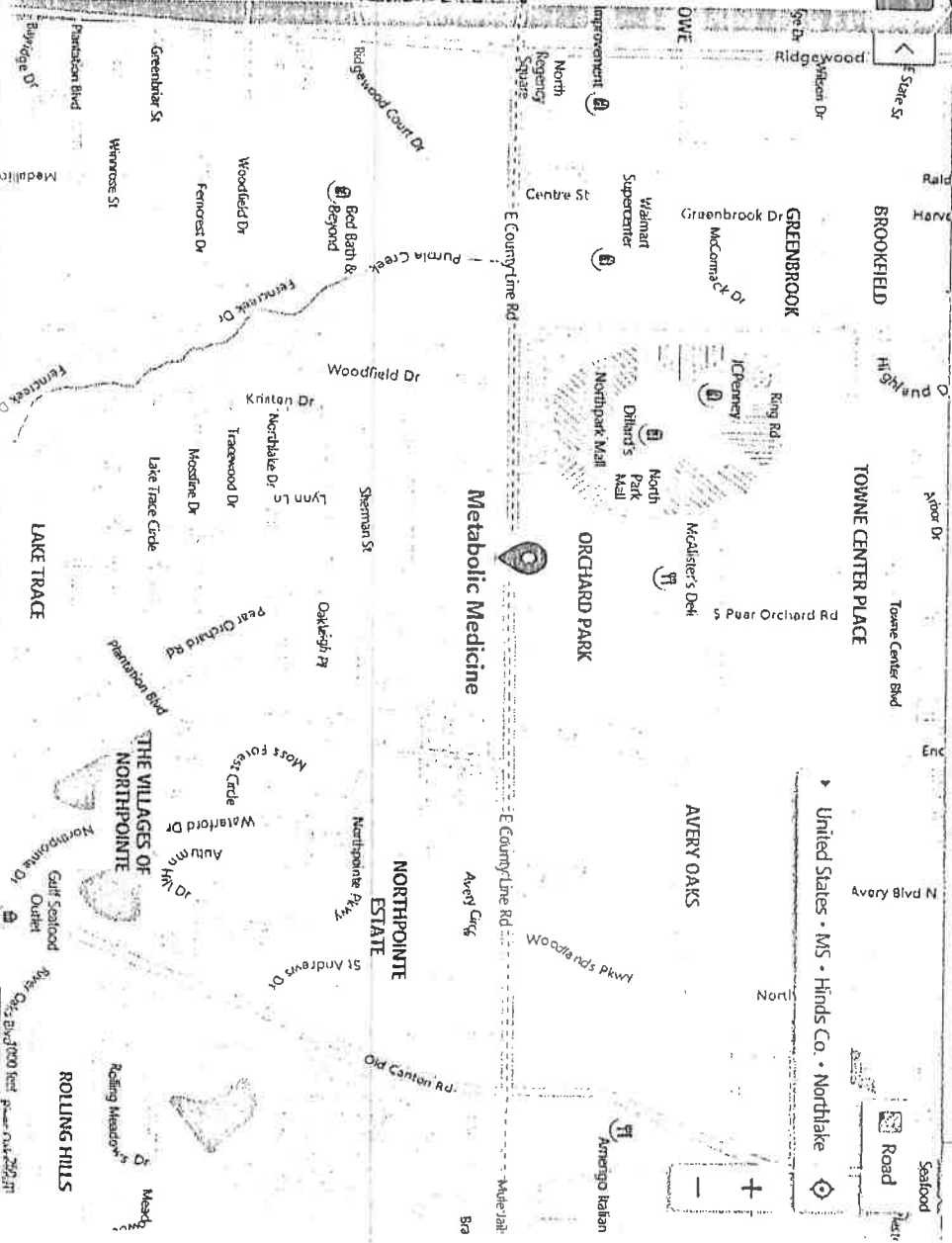



6130 N Hwy 55, Jackson, MS 39211 to
Metabolic Medicine of Mississippi

Drive 1.4 miles, 4 min

Coming from Jackson. Across Tico's steak house and Callaway's Yard and Garden

6130 N Hwy 55

Jackson, MS 39211

- ↑ 1. Head north on I-55 N
102 ft
- ↘ 2. Use the right lane to take exit 103 toward County Line Road/Ridgeland
0.2 mi
- ⤴ 3. Use the right lane to merge onto Interstate 55 North Frontage Rd
272 ft
- ↘ 4. Turn right onto E County Line Rd/N I-55 US Hwy 51
Ⓜ Continue to follow E County Line Rd
1.1 mi

Metabolic Medicine of Mississippi

1551 E County Line Rd, Jackson, MS 39211



I-55, Jackson, MS 39213 to Metabolic
Medicine of Mississippi

Coming from Ridgeland/Madison

I-55

Jackson, MS 39213

- ↑ 1. Head south on I-55 S
30 ft
- ↘ 2. Take exit 103 toward County Line Rd/Ridgeland
0.3 mi
- ⤴ 3. Continue onto Interstate 55 North Frontage Rd
469 ft
- ↙ 4. Use the left 2 lanes to turn left onto W County Line Rd (signs for East County Line Road/Frontage Road)
1.3 mi